

鹤山市2024年度第二十批次城镇建设用地上地红线图

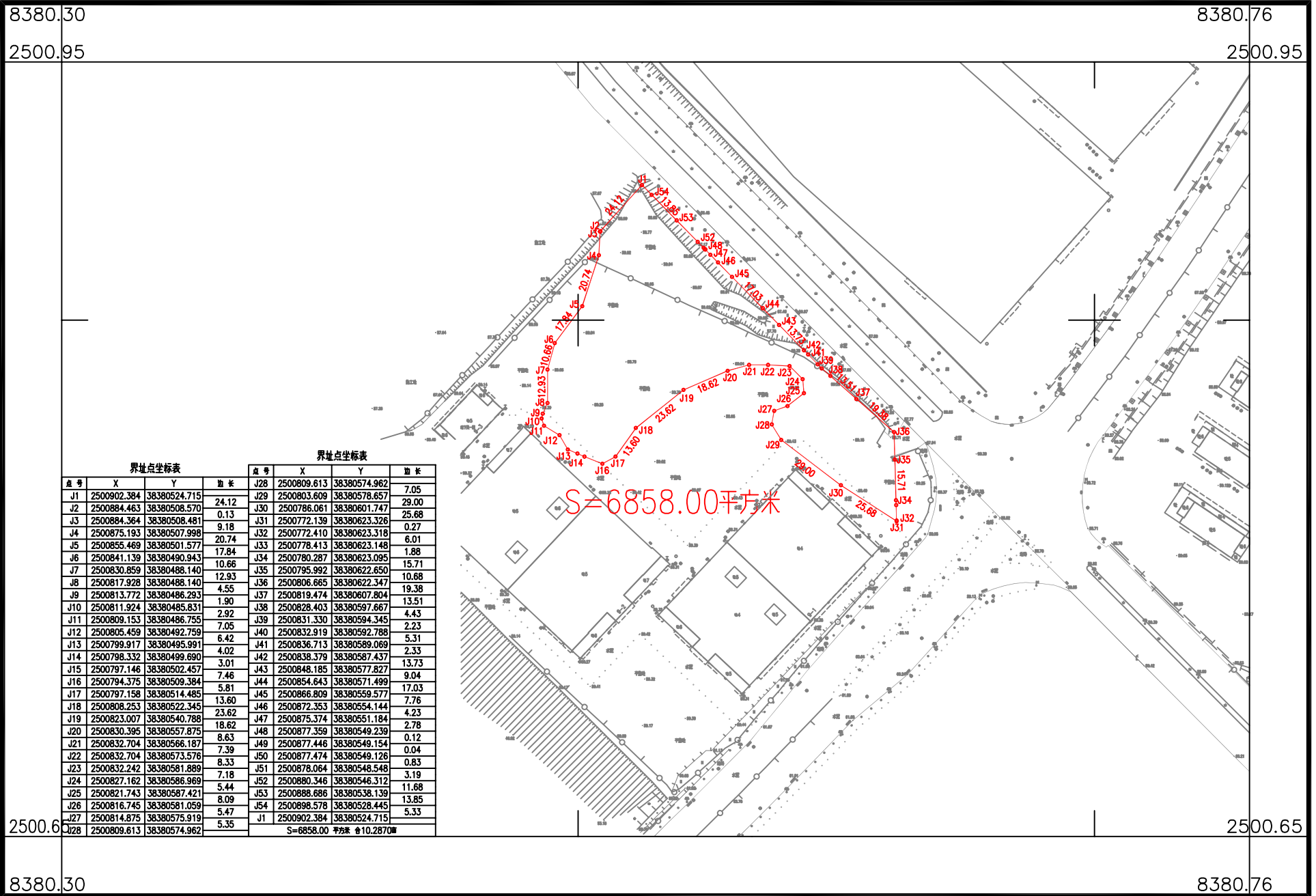

界址点坐标表

点号	X	Y	边长	点号	X	Y	边长
J1	2500902.384	38380524.715	24.12	J28	2500809.613	38380574.962	7.05
J2	2500884.463	38380508.570	0.13	J29	2500803.609	38380578.657	29.00
J3	2500884.364	38380508.481	9.18	J30	2500786.061	38380601.747	25.68
J4	2500875.193	38380507.998	20.74	J31	2500772.139	38380623.326	0.27
J5	2500855.469	38380501.577	17.84	J32	2500772.410	38380623.318	6.01
J6	2500841.139	38380490.943	10.66	J33	2500778.413	38380623.148	1.88
J7	2500830.859	38380488.140	12.93	J34	2500780.287	38380623.095	15.71
J8	2500817.928	38380488.140	4.55	J35	2500795.992	38380622.650	10.68
J9	2500813.772	38380486.293	1.90	J36	2500806.665	38380622.347	19.38
J10	2500811.924	38380485.831	2.92	J37	2500819.474	38380607.804	13.51
J11	2500809.153	38380486.755	7.05	J38	2500828.403	38380597.667	4.43
J12	2500805.459	38380492.759	6.42	J39	2500831.330	38380594.345	2.23
J13	2500799.917	38380495.991	4.02	J40	2500832.919	38380592.788	5.31
J14	2500798.332	38380499.690	3.01	J41	2500836.713	38380589.069	2.33
J15	2500797.146	38380502.457	7.46	J42	2500838.379	38380587.437	13.73
J16	2500794.375	38380509.384	5.81	J43	2500848.185	38380577.827	9.04
J17	2500797.158	38380514.485	13.60	J44	2500854.643	38380571.499	17.03
J18	2500808.253	38380522.345	23.62	J45	2500866.809	38380559.577	7.76
J19	2500823.007	38380540.788	18.62	J46	2500872.353	38380554.144	4.23
J20	2500830.395	38380557.875	8.63	J47	2500875.374	38380551.184	2.78
J21	2500832.704	38380566.187	7.39	J48	2500877.359	38380549.239	0.12
J22	2500832.704	38380573.576	8.33	J49	2500877.446	38380549.154	0.04
J23	2500832.242	38380581.889	7.18	J50	2500877.474	38380549.126	0.83
J24	2500827.162	38380586.969	5.44	J51	2500878.064	38380548.548	3.19
J25	2500821.743	38380587.421	8.09	J52	2500880.346	38380546.312	11.68
J26	2500816.745	38380581.059	5.47	J53	2500888.686	38380538.139	13.85
J27	2500814.875	38380575.919	5.35	J54	2500898.578	38380528.445	5.33
J28	2500809.613	38380574.962	5.35	J1	2500902.384	38380524.715	5.33

S=6858.00 平方米 合10.2870亩

鹤山市城乡规划建设院有限公司

2024年07月数字化制图
2000国家大地坐标系：中央子午线114度
1985国家高程基准，等高距为1米
2007年版式

1:2000

绘图员：张纯雯
检查员：段辉辉
审核员：谭锦峰